



**FYFE** Co.  
LLC

“THE FIBRWRAP® COMPANY”

# The Tyfo® Fibrwrap® Floor Slab Strengthening System

## Slab Strengthening

The Tyfo® Fibrwrap® Composite Systems can be used to increase the strength of existing slabs when the current load capacity is exceeded. Strengthening applications include the addition of dense filing systems, computer floors, topping slab material or heavy machinery.

When these additional loads are placed on a floor slab, the increased positive and negative moment requirements often exceed the current slab capacity. The Tyfo® Fibrwrap® Floor Slab Strengthening System works in conjunction with the existing steel reinforcement to provide an increase in flexural capacity.

The Tyfo® Fibrwrap® Systems can be placed either on the top or underside of a slab, depending on the strengthening requirements. The composite can then be covered with traditional flooring or ceiling materials.

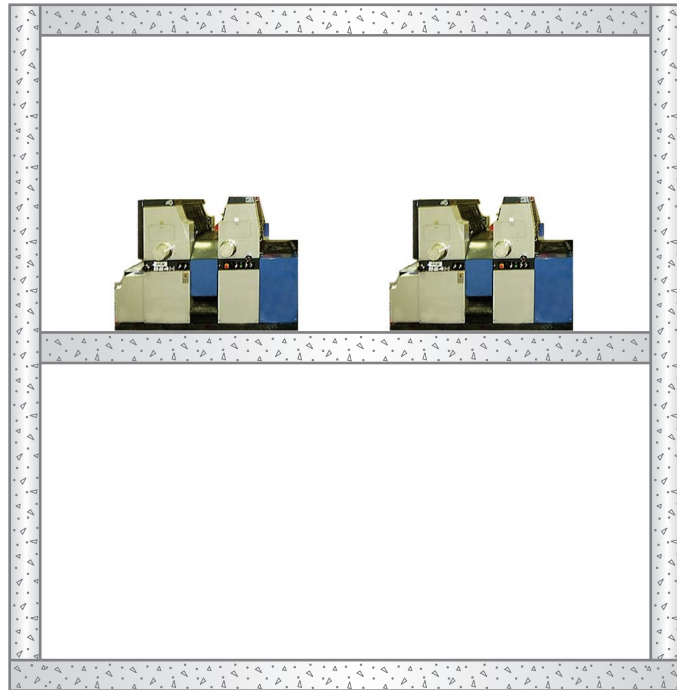

*Heavier equipment increases slab loading*

## Slab Strengthening Options

Conventional repairs can drastically increase the profile height and add unsightly structural elements. Such elements may also interfere with existing or proposed conduits, wiring, HVAC ducts, etc.

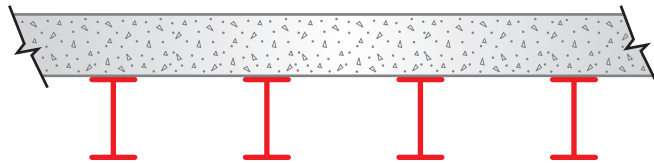

*Conventional Floor Slab Strengthening System*

The Tyfo® Fibrwrap® Floor Slab Strengthening System can provide the design requirements with minimal profile increase to the existing structure.

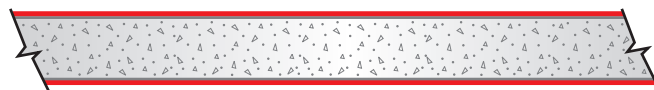

*Tyfo® Fibrwrap® Floor Slab Strengthening System*

- Build or Design-Build
- Cost-effective
- Easy to install
- No facility shutdown required



# Los Angeles Building

The Tyfo® Fibrwrap® System was used to strengthen the floor slab of an office building located in Los Angeles, CA. The addition of a new computer center on the 9<sup>th</sup> floor of this 28-story building increased the live and dead load to exceed the current slab capacity. Tyfo® SCH carbon composite was placed on both the underside and top of the slab for enhanced positive and negative flexural capacity. Other floors of the building were also voluntarily upgraded for increased slab capacity.



## Sears Lofts





# LAX Hilton



# La Jolla Galleria



# Getty Villa



## Fyfe Co. LLC

"The Fibrwrap® Company"

Nancy Ridge Technology Center

6310 Nancy Ridge Drive, Suite 103, San Diego, CA 92121-3209

Tel: 858.642.0694 Fax: 858.642.0947

E-mail: [info@fyfeco.com](mailto:info@fyfeco.com) Web: <http://www.fyfeco.com>